

1. CONTRACTOR TO VERIFY VERTICAL PROFILES TO CONSTRUCTION OF ALL UTILITIES.
2. CONTRACTOR SHALL CONTACT CITY OF WESTGATE PRIOR TO CONSTRUCTION TO OBTAIN MAIN WATER AND SEWER LINES.

EROSION CONTROL NOTE - TYPE CONSTRUCTION

1. This plan is intended to provide a general guide for the contractor. The contractor shall be responsible for obtaining all necessary permits and for ensuring that all construction is in accordance with all applicable codes and regulations.
2. The contractor shall be responsible for ensuring that all construction is in accordance with all applicable codes and regulations.
3. The contractor shall be responsible for ensuring that all construction is in accordance with all applicable codes and regulations.
4. The contractor shall be responsible for ensuring that all construction is in accordance with all applicable codes and regulations.
5. The contractor shall be responsible for ensuring that all construction is in accordance with all applicable codes and regulations.

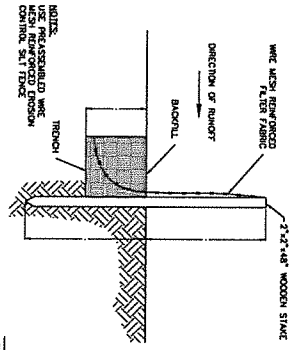

NO.	DESCRIPTION	QTY	UNIT
1	WOODEN STAKE	100	EA
2	WIRE MESH STRIP	100	EA
3	BARBED WIRE	100	EA
4	TRENCH	100	EA
5	GRAVEL STRIP	100	EA

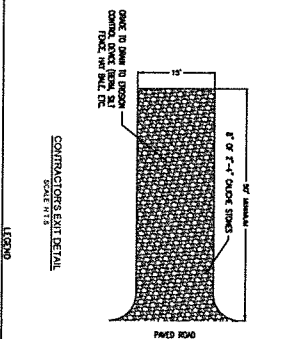

LEGEND

[Symbol]	PROP. 8" W/BACK
[Symbol]	PROP. 6" W/BACK
[Symbol]	PROP. 4" W/BACK
[Symbol]	PROP. 2" W/BACK
[Symbol]	PROP. 1" W/BACK
[Symbol]	PROP. 1/2" W/BACK
[Symbol]	PROP. 3/4" SAND STONE
[Symbol]	PROP. 1/2" SAND STONE
[Symbol]	PROP. 3/4" SAND STONE
[Symbol]	PROP. 1/2" SAND STONE
[Symbol]	PROP. 3/4" SAND STONE
[Symbol]	PROP. 1/2" SAND STONE

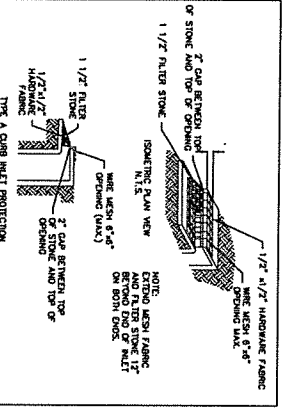

EROSION CONTROL NOTE - TYPE CONSTRUCTION

1. This plan is intended to provide a general guide for the contractor. The contractor shall be responsible for obtaining all necessary permits and for ensuring that all construction is in accordance with all applicable codes and regulations.
2. The contractor shall be responsible for ensuring that all construction is in accordance with all applicable codes and regulations.
3. The contractor shall be responsible for ensuring that all construction is in accordance with all applicable codes and regulations.
4. The contractor shall be responsible for ensuring that all construction is in accordance with all applicable codes and regulations.
5. The contractor shall be responsible for ensuring that all construction is in accordance with all applicable codes and regulations.



Moore Land Surveying, LLC
 2378 Lakewood Drive, Houston, TX 77052
 (281) 452-2860 Fax: (281) 452-2861
 1301 West Loop West, Suite 1000, Houston, TX 77027

WESTGATE ESTATES #2
EROSION & SEDIMENT CONTROL PLAN

DATE	2/28/18
SHEET	1 OF 2
DRAWING NO.	18-001

REVISIONS

NO.	1	DATE	2/28/18	DESCRIPTION
2	3/1/18	3/1/18	3/1/18	3/1/18
3	3/1/18	3/1/18	3/1/18	3/1/18
4	3/1/18	3/1/18	3/1/18	3/1/18
5	3/1/18	3/1/18	3/1/18	3/1/18

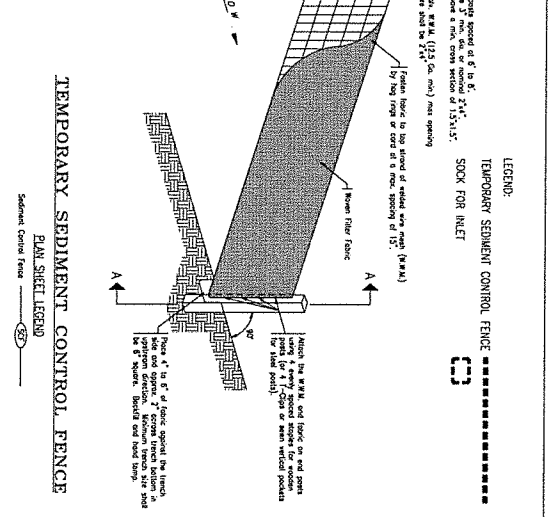
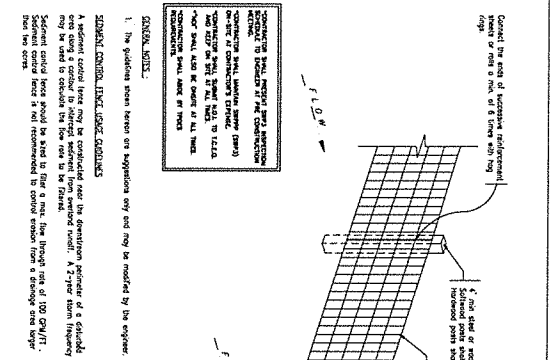
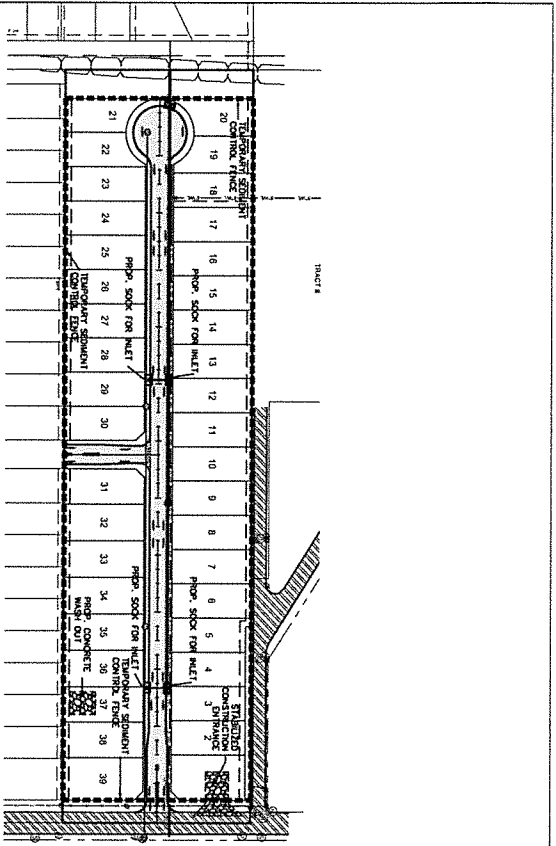

GENERAL NOTES:

- The guidelines shown herein are suggestions only and may be modified by the engineer.
- A sediment control fence may be constructed near the downstream extremity of a drainage area if the flow rate is less than 100 GPM/FT. Sediment control fences are not recommended to control erosion from a drainage area larger than 100 GPM/FT.

SOCKS AND SOCKS:

- The guidelines shown herein are suggestions only and may be modified by the engineer.

SOCKS AND SOCKS:

- The guidelines shown herein are suggestions only and may be modified by the engineer.

NO.	DATE	BY
1	7/12/2011	ML
2		
3		
4		
5		
6		
7		
8		
9		
10		
11		
12		
13		
14		
15		
16		
17		
18		
19		
20		
21		
22		
23		
24		
25		
26		
27		
28		
29		
30		
31		
32		
33		
34		
35		
36		
37		
38		
39		

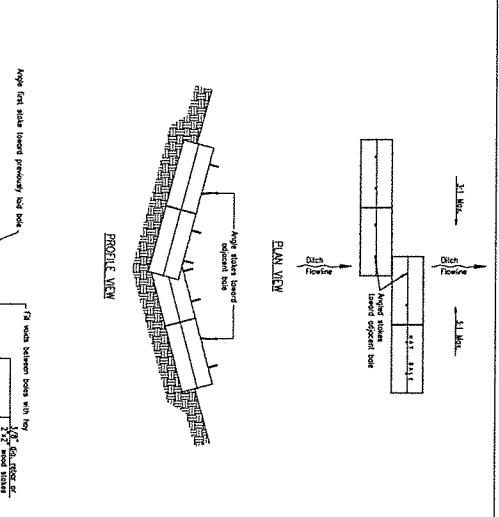
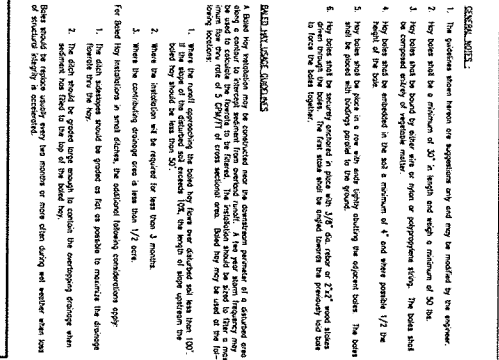
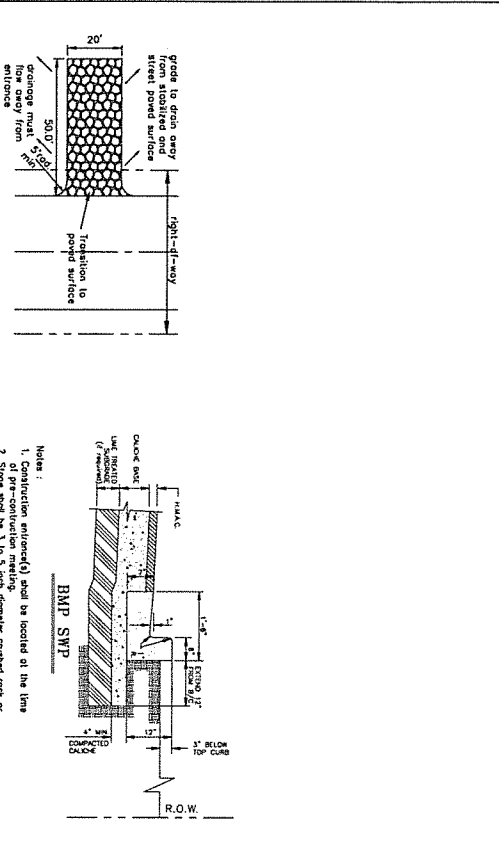

GENERAL NOTES:

- The guidelines shown herein are suggestions only and may be modified by the engineer.
- A sediment control fence may be constructed near the downstream extremity of a drainage area if the flow rate is less than 100 GPM/FT. Sediment control fences are not recommended to control erosion from a drainage area larger than 100 GPM/FT.

SOCKS AND SOCKS:

- The guidelines shown herein are suggestions only and may be modified by the engineer.

SOCKS AND SOCKS:

- The guidelines shown herein are suggestions only and may be modified by the engineer.

NO.	DATE	BY
1	7/12/2011	ML
2		
3		
4		
5		
6		
7		
8		
9		
10		
11		
12		
13		
14		
15		
16		
17		
18		
19		
20		
21		
22		
23		
24		
25		
26		
27		
28		
29		
30		
31		
32		
33		
34		
35		
36		
37		
38		
39		

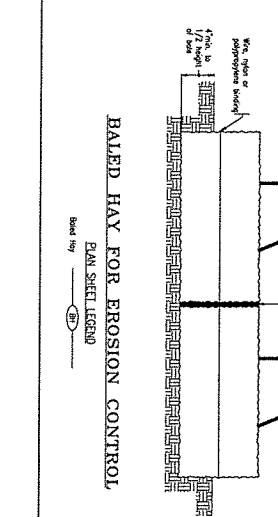
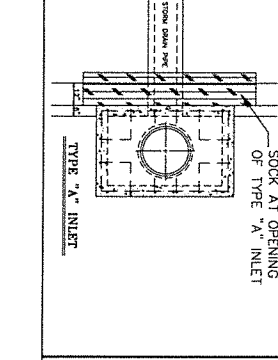
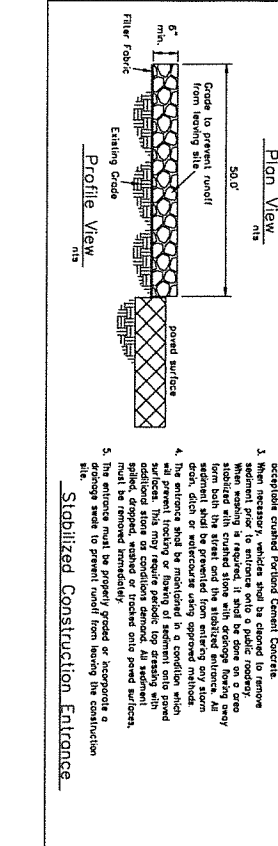

GENERAL NOTES:

- The guidelines shown herein are suggestions only and may be modified by the engineer.
- A sediment control fence may be constructed near the downstream extremity of a drainage area if the flow rate is less than 100 GPM/FT. Sediment control fences are not recommended to control erosion from a drainage area larger than 100 GPM/FT.

SOCKS AND SOCKS:

- The guidelines shown herein are suggestions only and may be modified by the engineer.

SOCKS AND SOCKS:

- The guidelines shown herein are suggestions only and may be modified by the engineer.

NO.	DATE	BY
1	7/12/2011	ML
2		
3		
4		
5		
6		
7		
8		
9		
10		
11		
12		
13		
14		
15		
16		
17		
18		
19		
20		
21		
22		
23		
24		
25		
26		
27		
28		
29		
30		
31		
32		
33		
34		
35		
36		
37		
38		
39		

**STORMWATER POLLUTION PREVENTION PLAN
(SWP3)**

**NEW CONSTRUCTION OF
KING ESTATES SUBDIVISION
WESLACO, TEXAS**

**FOR:
FRED PEREZ, JR.**

March 13, 2018



BY:

MELDEN & HUNT, INC.
Engineers • Surveyors • Consultants

115 W. McIntyre St.
Edinburg, TX 78541

Tel: (956) 381-0981
Fax: (956) 381-1839
Job Number: 17122.13

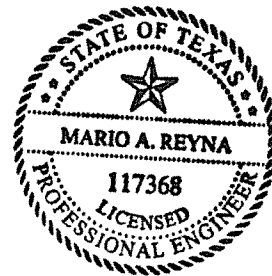

Mario Reyna
3-13-18

STORM WATER POLLUTIONS PREVENTION PROGRAM

CERTIFICATION STATEMENT

FOR

KING ESTATES SUBDIVISION
WESLACO, TEXAS

"I CERTIFY UNDER PENALTY OF LAW THAT I WILL ADHERE TO THE REQUIREMENTS OF THIS DOCUMENT AND ALL ATTACHMENTS IN ACCORDANCE WITH A SYSTEM DESIGNED TO ASSURE THAT STORM WATER POLLUTION IS PREVENTED. I AM AWARE THAT THERE ARE SIGNIFICANT PENALTIES FOR SUBMITTING FALSE INFORMATION, INCLUDING, THE POSSIBILITY OF FINE AND IMPRISONMENT FOR KNOWING VIOLATIONS."

OPERATOR CERTIFICATION:

NAME (PRINT): TOTAL COMMITMENT CONSTRUCTION CO., LLC

DATE: 3-19-2018

SIGNATURE: _____

NAME (PRINT): Mando Gutierrez

TITLE: owner

ADDRESS: 36970 W Mile 7 Rd

CITY: Mission

STATE: Texas

ZIP CODE: 78574